

REV	ECO	DWN	DATE
E	20041920	ELL	28-DEC-99
F	20070525	RLL	02-OCT-00

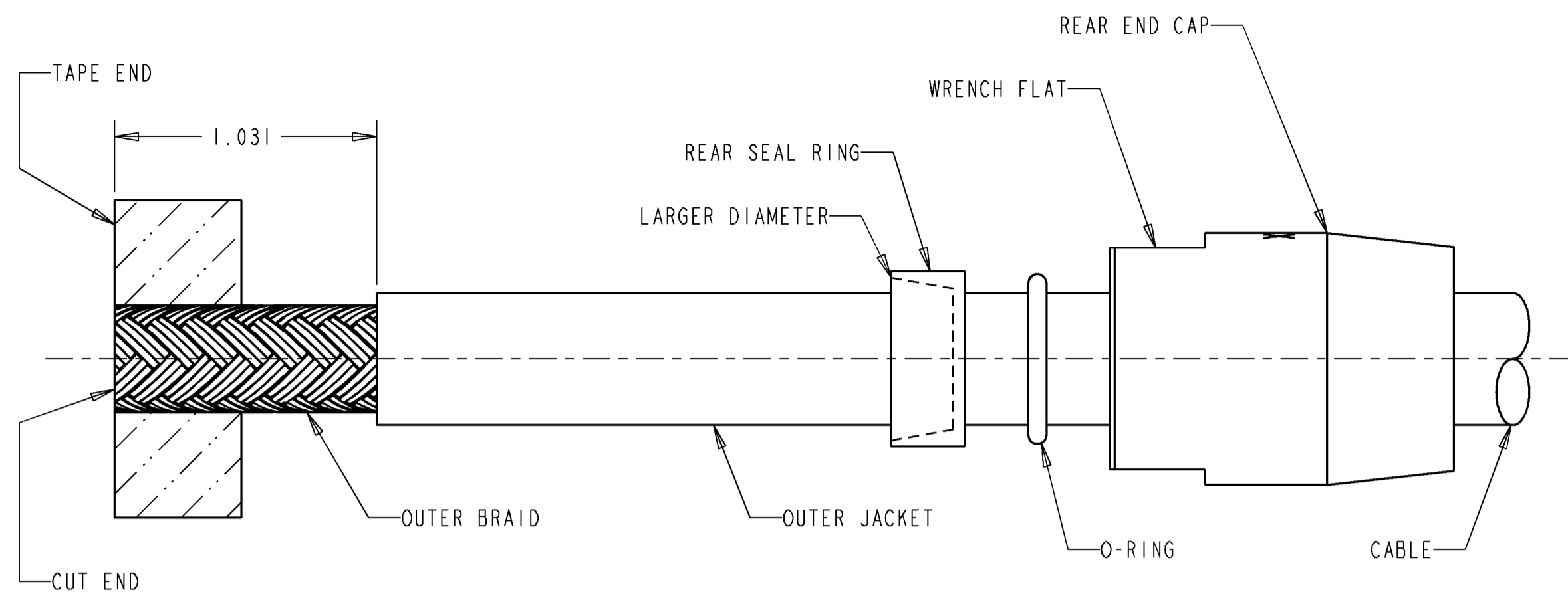

1. CUT CABLE END SQUARE. SLIDE END CAP AND REAR SEAL RING OVER THE OUTER JACKET OF CABLE. ORIENTATE REAR SEAL RING SO THAT THE LARGER DIAMETER IS FACING TOWARDS THE CUT END OF CABLE AS SHOWN BY HIDDEN LINE.
2. REMOVE OUTER JACKET TO 1.031" DIMENSION AS SHOWN. WRAP THE END OF THE OUTER BRAID WITH TAPE TO RETAIN THE BRAID FOR ASSEMBLING THE THREADED INSERT.

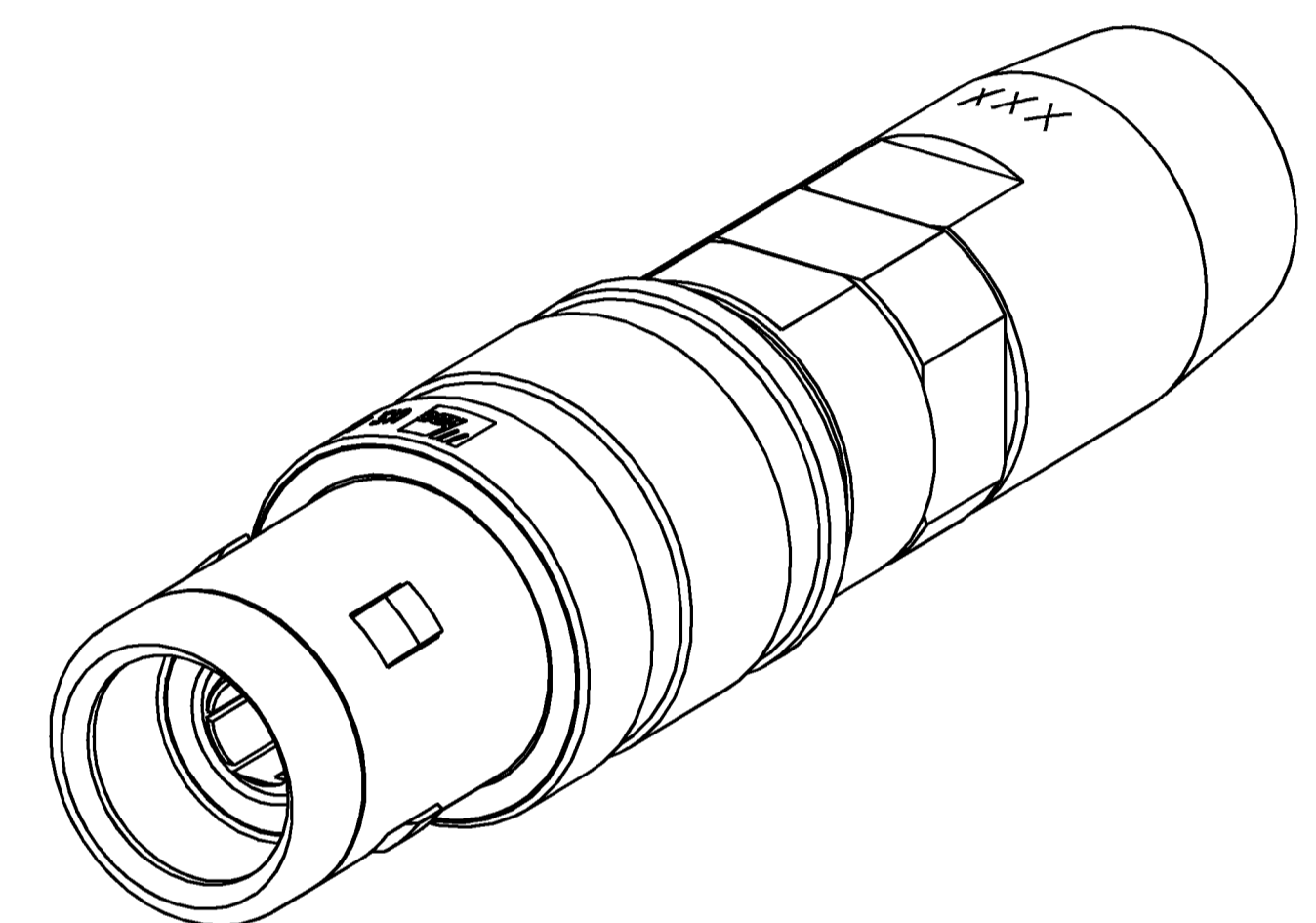

NOTE:  
 ADC LOOSLY PRE-ASSEMBLE MALE CONNECTOR FOR SHIPMENT TO CUSTOMER (AS SHOWN ABOVE). CUSTOMER IS TO UNASSEMBLY MALE CONNECTOR AND FOLLOW INSTRUCTIONS OF THIS INSTALLATION DRAWING FOR MOUNTING CABLE TO CONNECTOR.

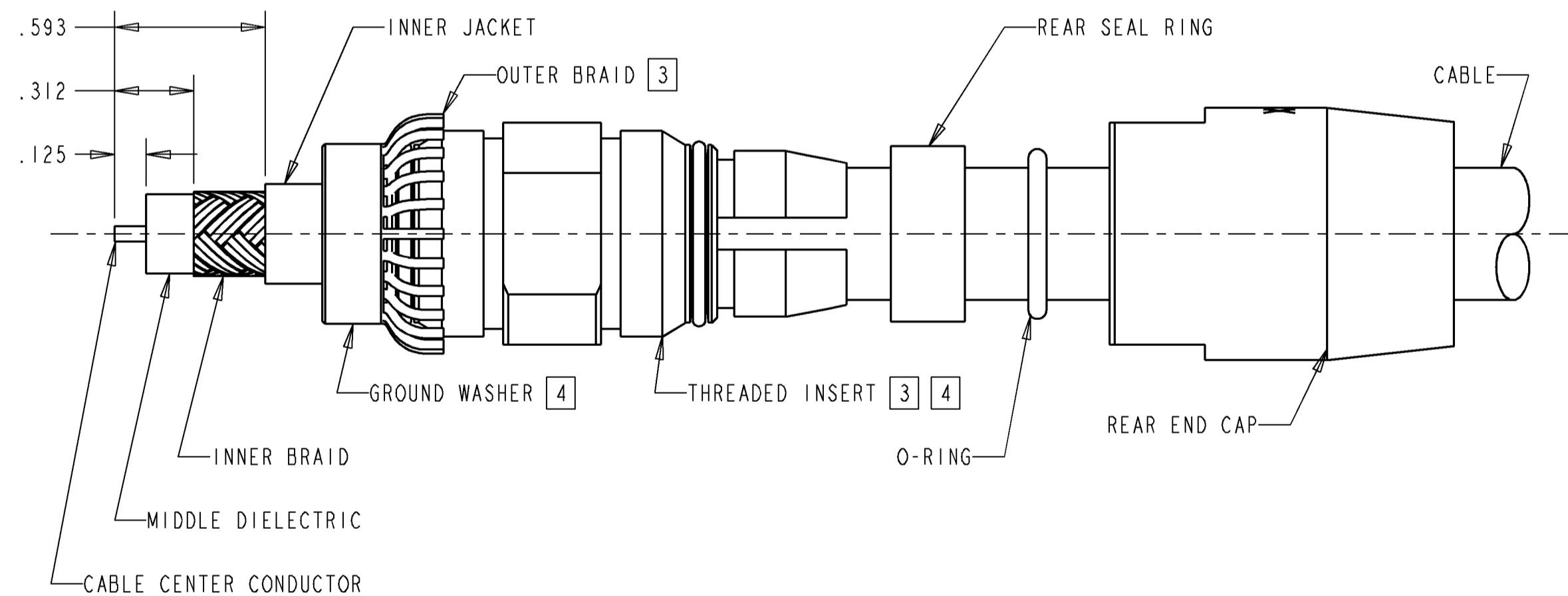

- [3] PLACE THREADED INSERT OVER THE OUTER JACKET OF CABLE AND REMOVE TAPE. PULL BACK OUTER BRAID OVER THREADED INSERT.
- [4] PLACE GROUND WASHER OVER THE OUTER BRAID AND SEAT AGAINST THE THREADED INSERT AND PRESS.
5. REMOVE INNER JACKET AND INNER BRAID TO .312" DIMENSION. REMOVE INNER JACKET AN ADDTIONAL .281". DO NOT NICK BRAID.
6. REMOVE MIDDLE DIELECTRIC TO .125" DIMENSION TO EXPOSE CABLE CENTER CONDUCTOR. DO NOT NICK OR UNRAVEL CENTER CONDUCTOR.

TCP-F14	Ø .250
TCP-E38	Ø .315
TCP-D38	Ø .410
TCP-C12	Ø .520
TCP-A12	Ø .475
TCP-B38	Ø .360
CATALOG NUMBER	CABLE SIZE/DIA



INFORMATION ON THIS DOCUMENT IS PROPRIETARY TO ADC AND SHALL NOT BE USED, COPIED, REPRODUCED OR DISCLOSED IN WHOLE OR IN PART WITHOUT WRITTEN CONSENT OF ADC.

TOLERANCE UNLESS OTHERWISE SPECIFIED: .XX: ±N/A, .XXX: ±N/A, ANGULAR: ±N/A

THIRD ANGLE PROJECTION

DO NOT SCALE DRAWING

ENGR: MIKE FOLLINGSTAD  
 DWN: LOREN MATTSO

TITLE: PROAX TRIAXIAL CONN. MALE, INST DWG

DRAWING NUMBER: 1014820

SHT. 1 OF 3

REV	ECO	DWN	DATE

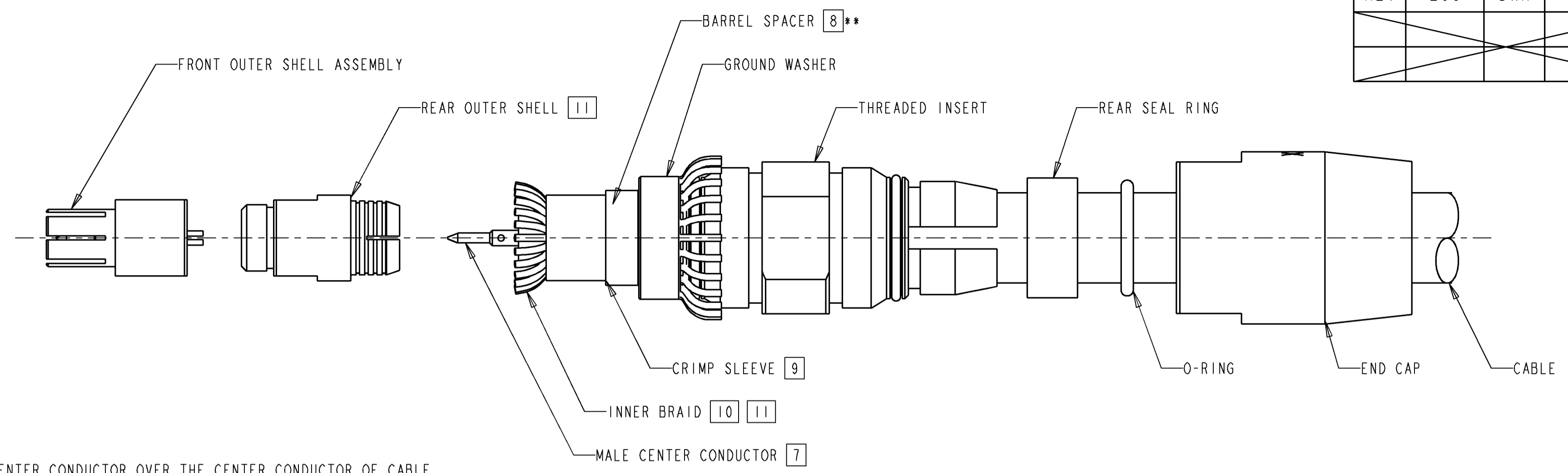

- 7 SLIDE MALE CENTER CONDUCTOR OVER THE CENTER CONDUCTOR OF CABLE AND BUTT IT AGAINST THE CORE. CRIMP OR SOLDER THE CONTACT TO THE MIDDLE DIELECTRIC AS SHOWN.
- 8 SLIDE BARREL SPACER OVER INNER JACKET AND BUTT-UP AGAINST THE GROUND WASHER
- 9 SLIDE CRIMP SLEEVE OVER OUTER JACKET AND BUTT-UP TO THE GROUND WASHER.

- 10 FRAY INNER BRAID OUT AND PRESS THE REAR OUTER SHELL OVER THE MIDDLE DIELECTRIC.
- 11 PULL INNER BRAID OVER REAR OUTER SHELL. (NOTE: CAUTION MUST BE EXERCISED NOT TO ALLOW ANY OF THE BRAID TO REMAIN INSIDE THE REAR OUTER SHELL.)

\*\* NOTE: SMALLER SIZE CABLE WILL NEED A SPLIT STYLE BARREL. THIS SHOULD BE PUT ON AFTER THE CRIMP SLEEVE HAS BEEN CRIMPED AND SHOULD FIT BETWEEN THE REAR OUTER SHELL AND THE GROUND WASHER.

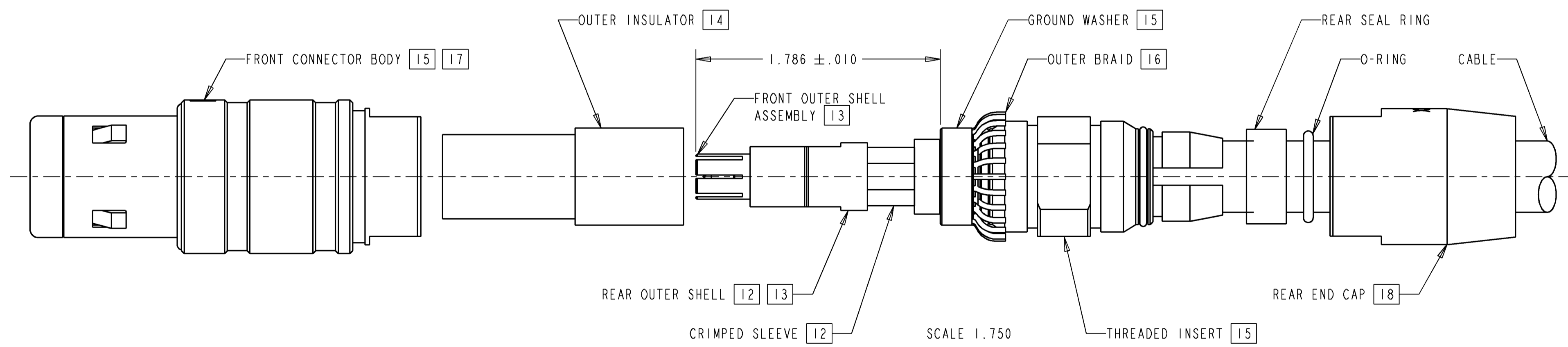

- 12 SLIDE CRIMP SLEEVE OVER THE INNER BRAID AND THE REAR OUTER SHELL AND USING CRIMPING TOOL, CRIMP AROUND CRIMP SLEEVE AS SHOWN.
- 13 SCREW IN FRONT OUTER SHELL ASSEMBLY INTO REAR OUTER SHELL WHILE ALIGNING CENTER CONDUCTORS AND TIGHTEN DOWN.
- 14 INSERT OUTER INSULATOR OVER THE OUTER SHELL ASSEMBLY.

- 15 ADJUST THE THREADED INSERT AND GROUND WASHER FORWARD SO IT MATES FLUSH WITH OUTER INSULATOR.
- 16 TRIM EXCESS BRAID THAT EXTENDS BEYOND THE OUTER DIAMETER OF THE GROUND WASHER AS SHOWN.
- 17 SCREW FRONT CONNECTOR BODY OVER OUTER INSULATOR AND INTO THREADED INSERT. TIGHTEN USING A PAIR OF 7/8" WRENCHES.
- 18 SCREW REAR END CAP INTO THREADED INSERT. TIGHTEN USING A PAIR OF 7/8" WRENCHES.

SCALE 1.750



INFORMATION ON THIS DOCUMENT IS PROPRIETARY TO ADC AND SHALL NOT BE USED, COPIED, REPRODUCED OR DISCLOSED IN WHOLE OR IN PART WITHOUT WRITTEN CONSENT OF ADC.		TITLE PROAX TRIAXIAL CONN. MALE, INST DWG	
TOLERANCE UNLESS OTHERWISE SPECIFIED .XX: ±N/A .XXX: ±N/A ANGULAR: ±N/A	C SIZE	DRAWING NUMBER 1014820	F REV
THIRD ANGLE PROJECTION DO NOT SCALE DRAWING	ENGR: MIKE FOLLINGSTAD DWN: LOREN MATTSO		SHT. 2 OF 3

REV	ECO	DWN	DATE

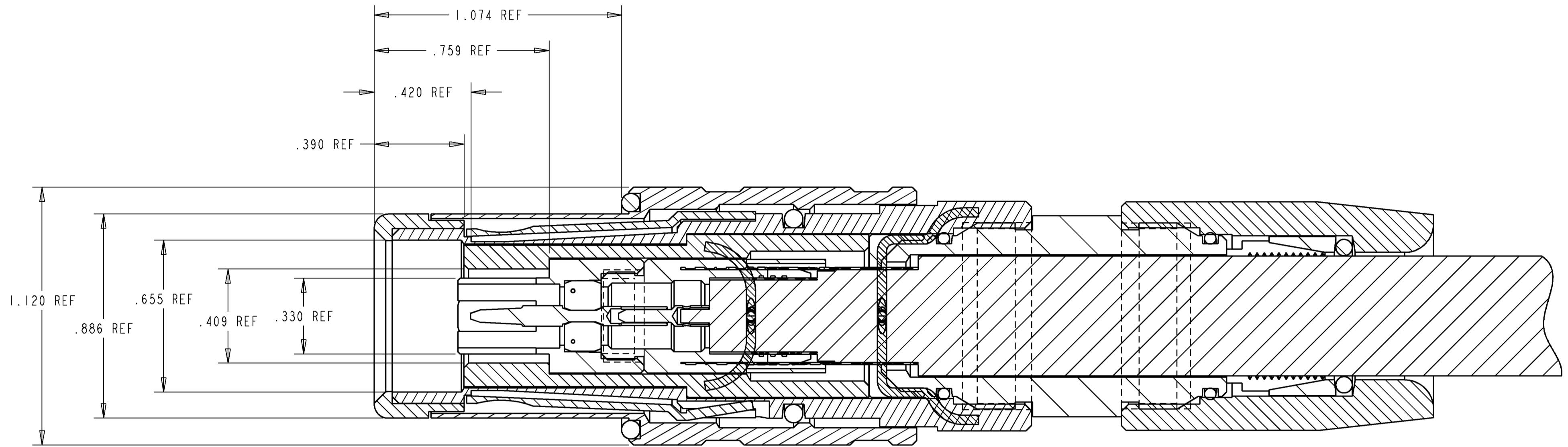

SECTION A-A  
SCALE 3.00  
INTERFACE DIMENSIONS DETAIL



<small>INFORMATION ON THIS DOCUMENT IS PROPRIETARY TO ADC AND SHALL NOT BE USED, COPIED, REPRODUCED OR DISCLOSED IN WHOLE OR IN PART WITHOUT WRITTEN CONSENT OF ADC.</small>		<b>TITLE</b> PROAX TRIAXIAL CONN. MALE, INST DWG	
<small>TOLERANCE UNLESS OTHERWISE SPECIFIED</small> .XX: ±N/A .XXX: ±N/A ANGULAR: ±N/A	<b>C</b> <small>SIZE</small>	<small>DRAWING NUMBER</small> 1014820	<small>F</small> <small>REV</small>
<small>THIRD ANGLE PROJECTION</small> 	<small>DO NOT SCALE DRAWING</small>	<small>ENGR: MIKE FOLLINGSTAD</small> <small>DWN: LOREN MATTSON</small>	<small>SHT. 3 OF 3</small>